

LANZAROTE AND FUERTEVENTURA ROOMS (TOTAL: 83 m²)

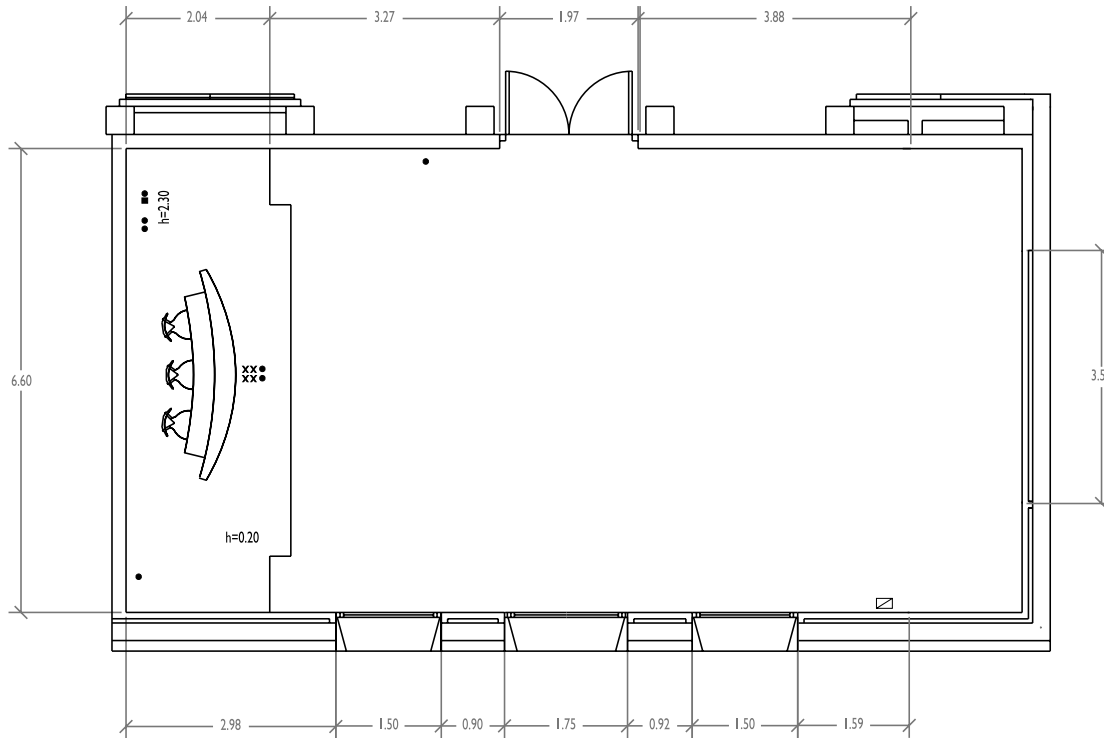

- ▣ AUDIO DISTRIBUTION SWITCHBOARD
- X V+D POINT
- POWER POINT 10/16A
- TV MONITOR POINT

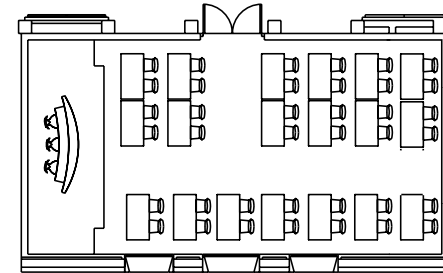

CAPACITY : 38 PEOPLE LANZAROTE
36 PEOPLE FUERTEVENTURA

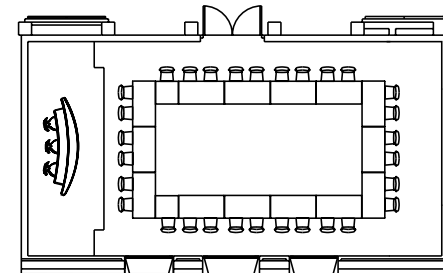

CAPACITY : 30 PEOPLE

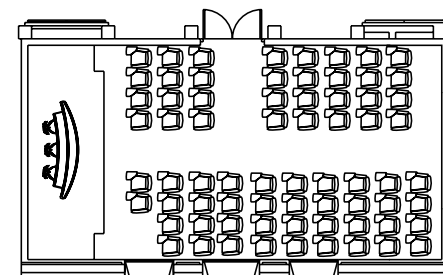

CAPACITY : 70 PEOPLE



DESCRIPTION

Rooms located at basement and lower levels [-2 & -1] of the Convention Centre with the following specifications:

Capacity: 70 people in theatre layout	Surface: 83 m ² (6.6x12.6 m)
38 people in classroom layout (Lanzarote room)	Height: 2.50 m
36 people in classroom layout (Fuerteventura room)	Stage: 13.50 m ²
30 people in imperial layout (Both rooms)	Stage height: 0.20 m

FURNISHINGS

- Chairs and tables in theatre, classroom or imperial layout. In case of theatre layout, possibility of chairs with notepad arm.
- Lectern, table and chairs for the presidency.

EQUIPMENT AND SUPPLIES IN THE ROOM

- Local megaphony (fixed microphones in the presiding table).
- Air conditioning.
- Ambient lighting and power points (10/16 A).
- Data lan, image and data transmission.
- Fire detection, alarm, evacuation and extinction services.

OPTIONAL SERVICES

- Equipment for sound and image projection and recording.
- Simultaneous translation cabins with infrared system.
- Videoconferencing.
- Cordless megaphony.
- Floral decoration.
- Signwriting.
- Audiovisual, light and sound and decor assembly technicians, congress hostesses, translators, security guards, etc.